

ZSWalls+R : Mastering uncertainties in deep excavations calculations

Marc Gros Lambert GeoMod SA

August 2022

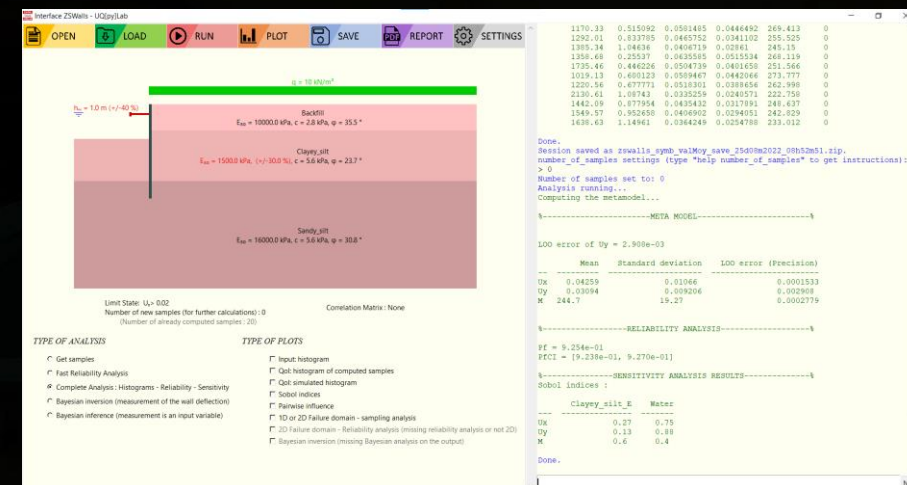
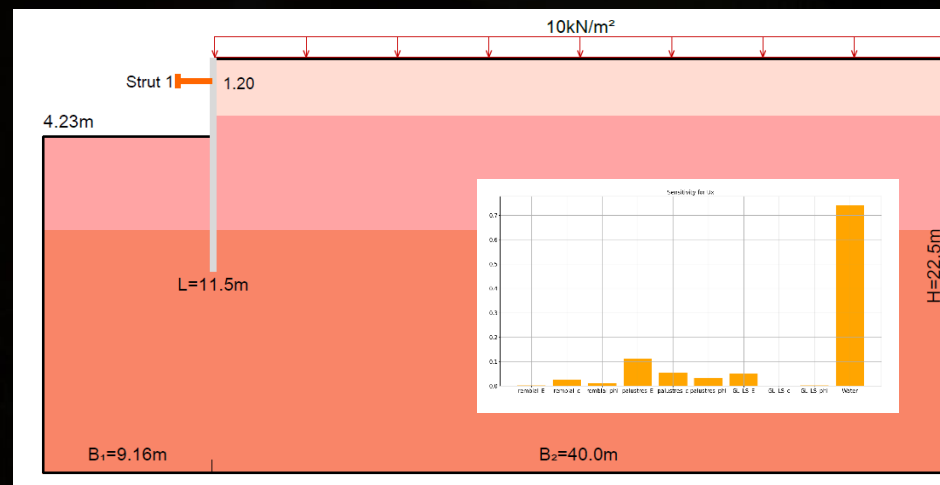

Outline

- Zswalls + R : presentation
- Example of probabilistic analysis
 - presentation of the case
 - complete analysis
 - interpretation

The power of Bayes with ZSWalls + R

=> to be able to create UQ analysis for real-life projects

Workflow of the ZSWalls – UQLab interface :

- Import a ZSWalls file
- Assign probabilistic variables
- Get samples of the variable and compute the results with ZSWalls
- Build a PCE to surrogate ZSWalls calculations
- Do a UQ analysis : reliability, sensitivity, Bayes...

Quantities of Interest for excavations :

- U_x : maximal wall deflection
- U_y : maximal settlement behind the wall
- M : maximal bending moment

Study case : Bayesian analysis with a ZSWalls model

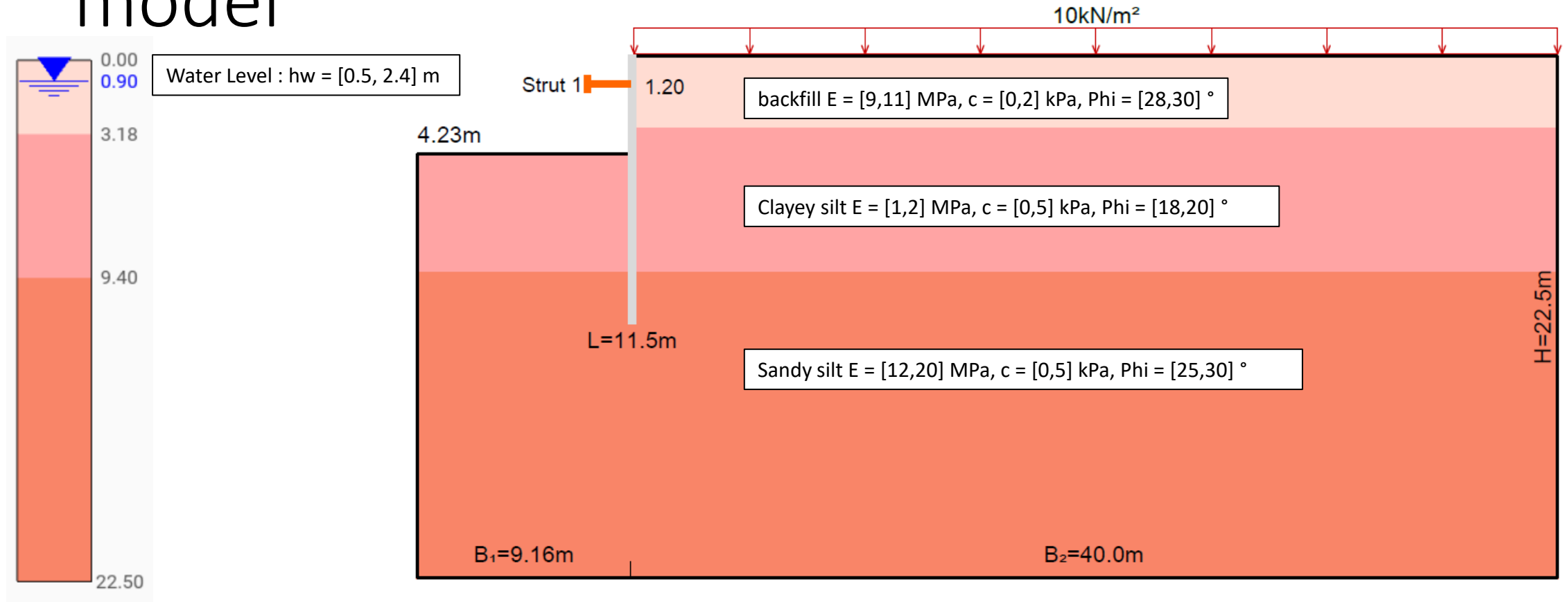

Field observation :

At a depth of 1m, after 1.9m excavated, before placing the strut, the horizontal displacement of the wall is 2.25cm

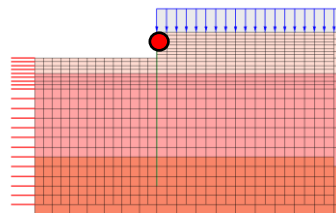

Time⁴ = 15

T=0

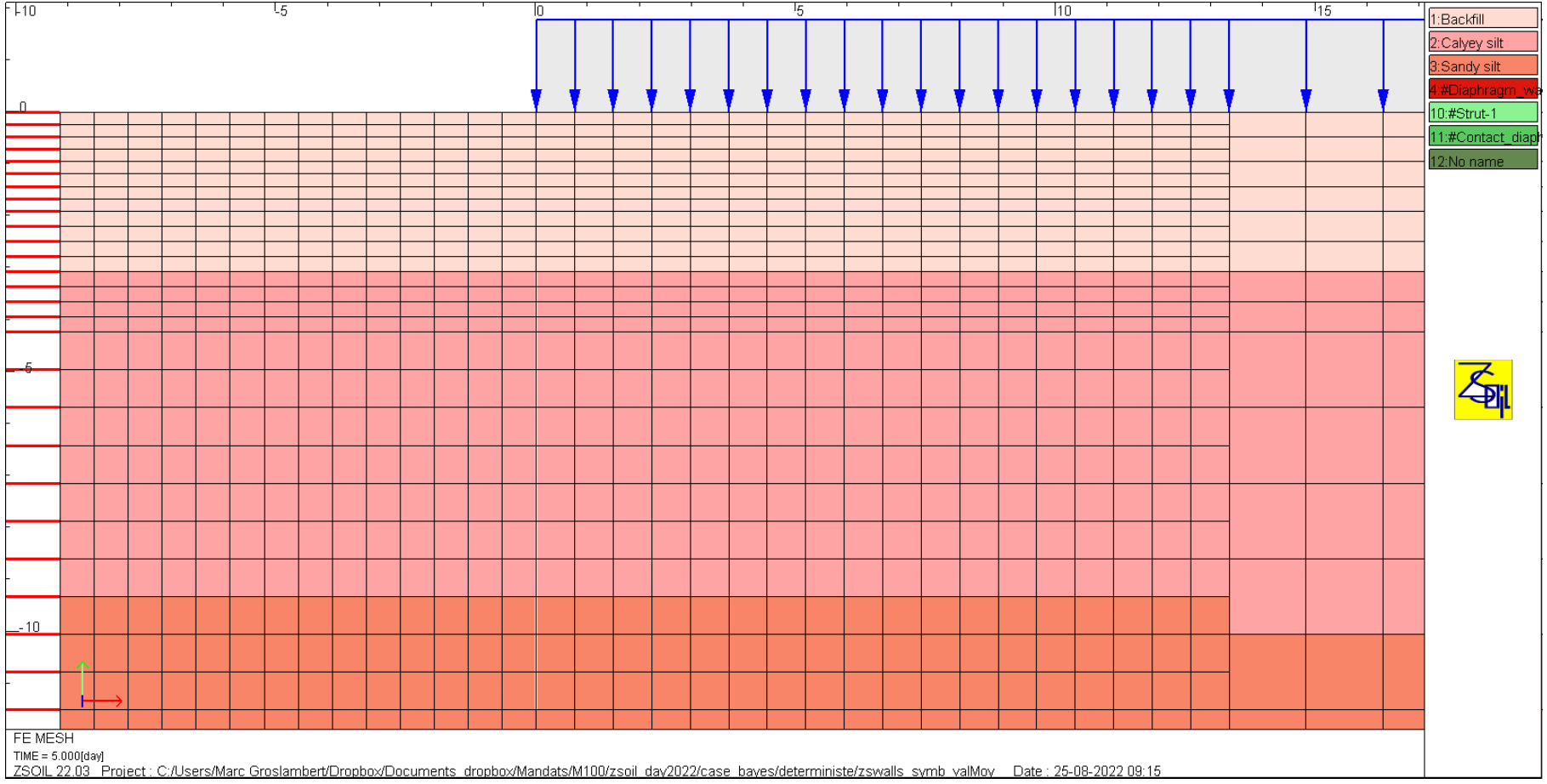

T=10

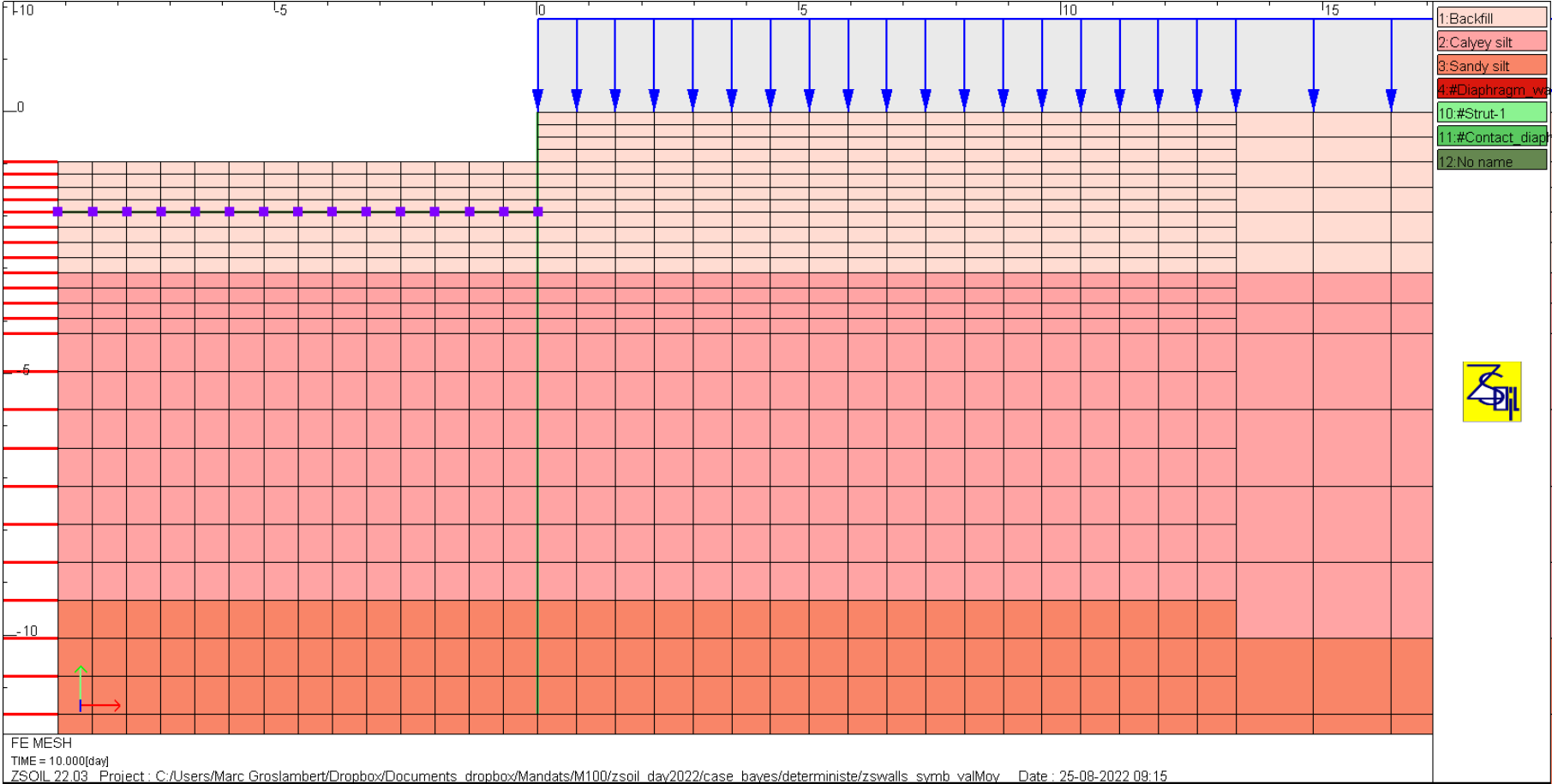

T=15

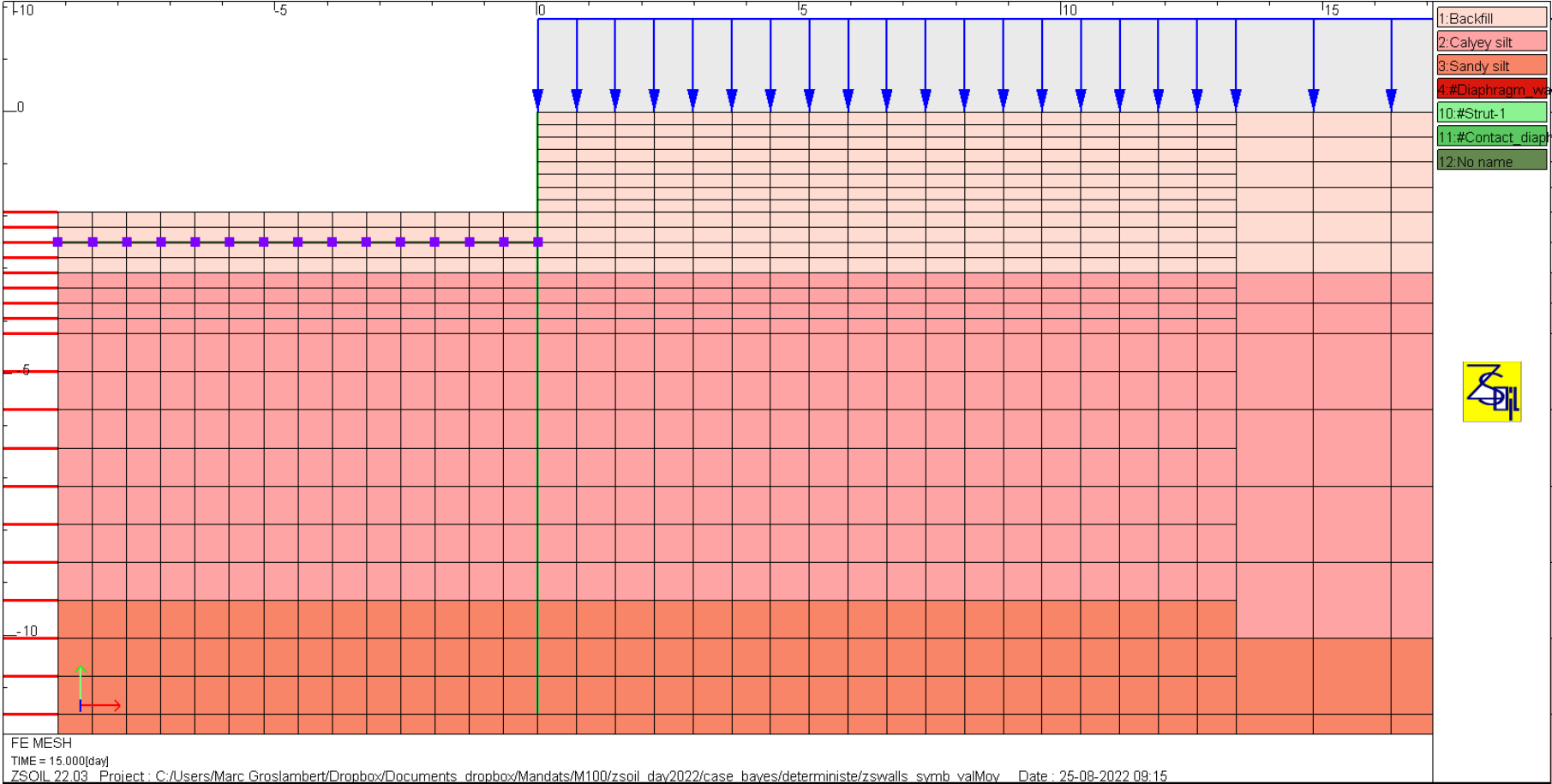

T=40

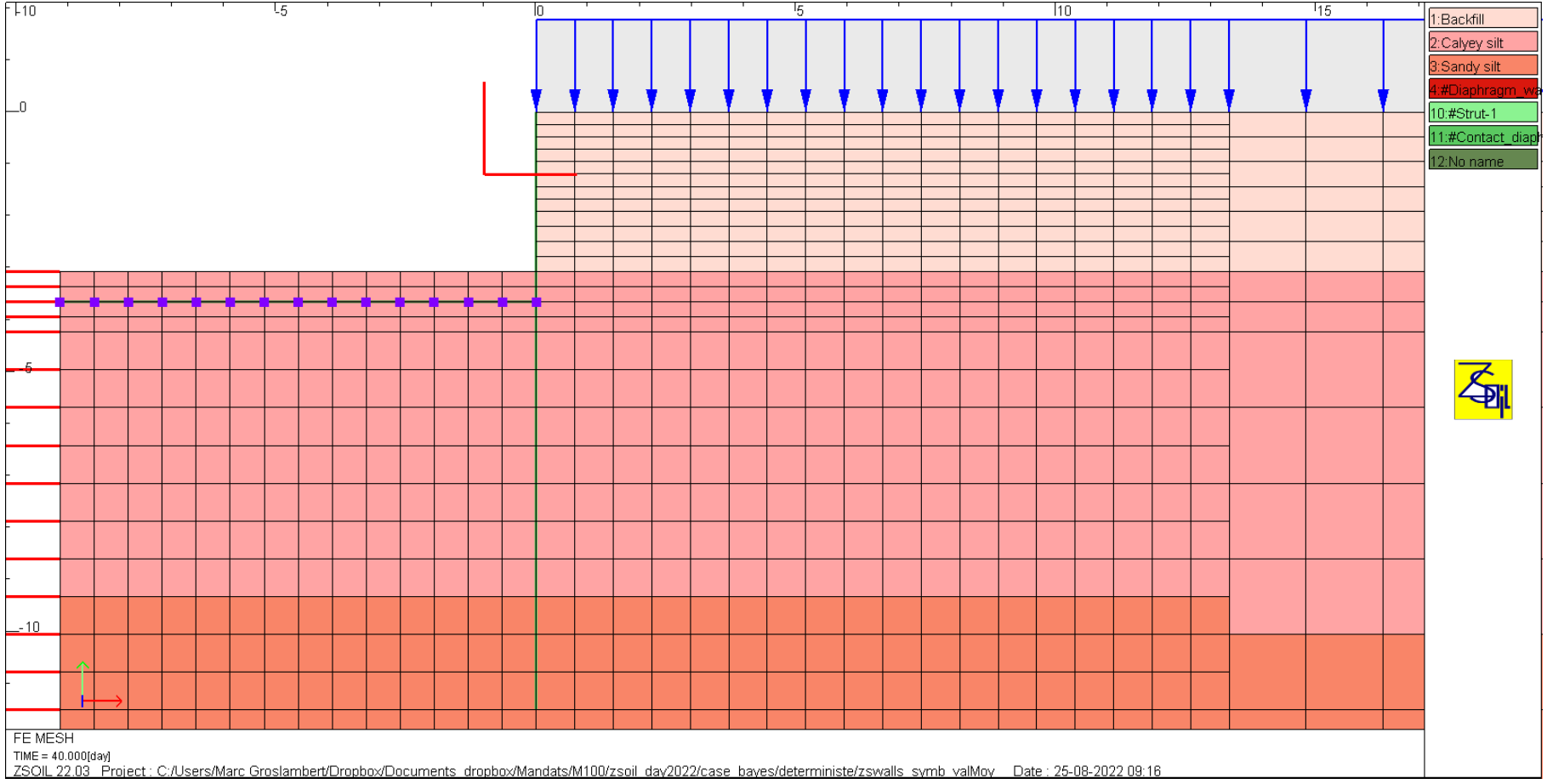

T=65

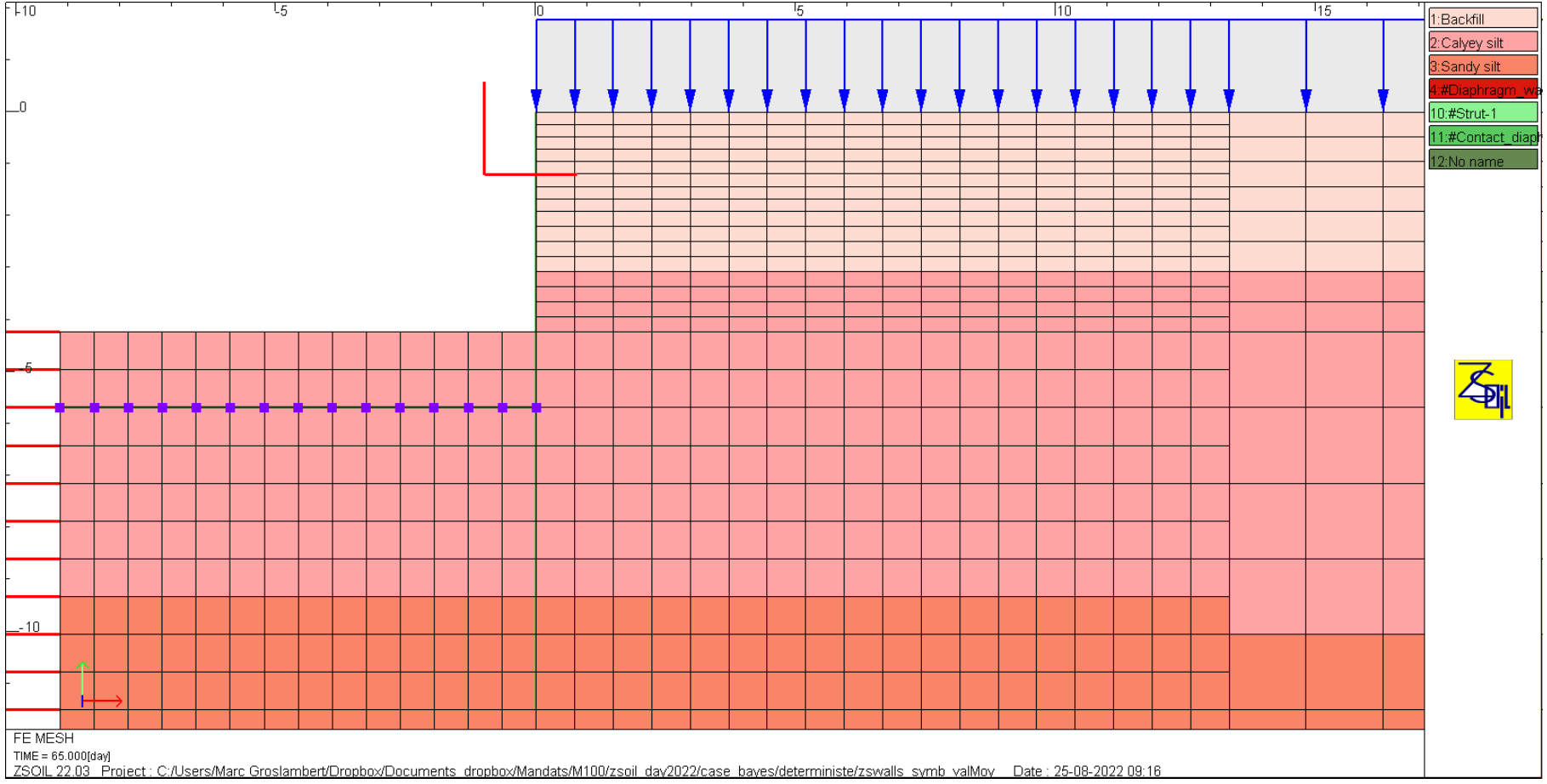

Focus on U_x , U_y

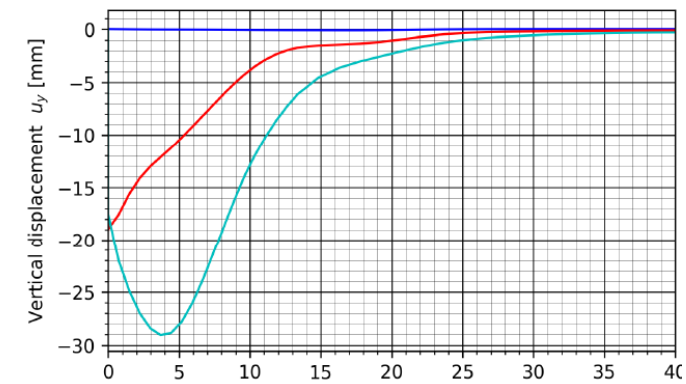
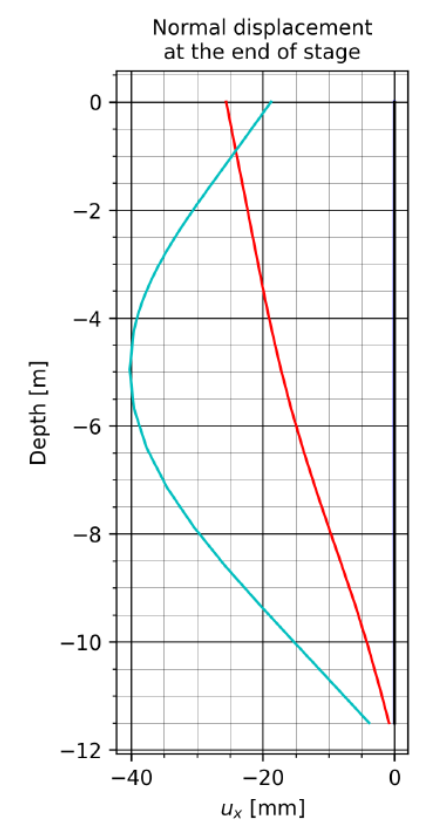
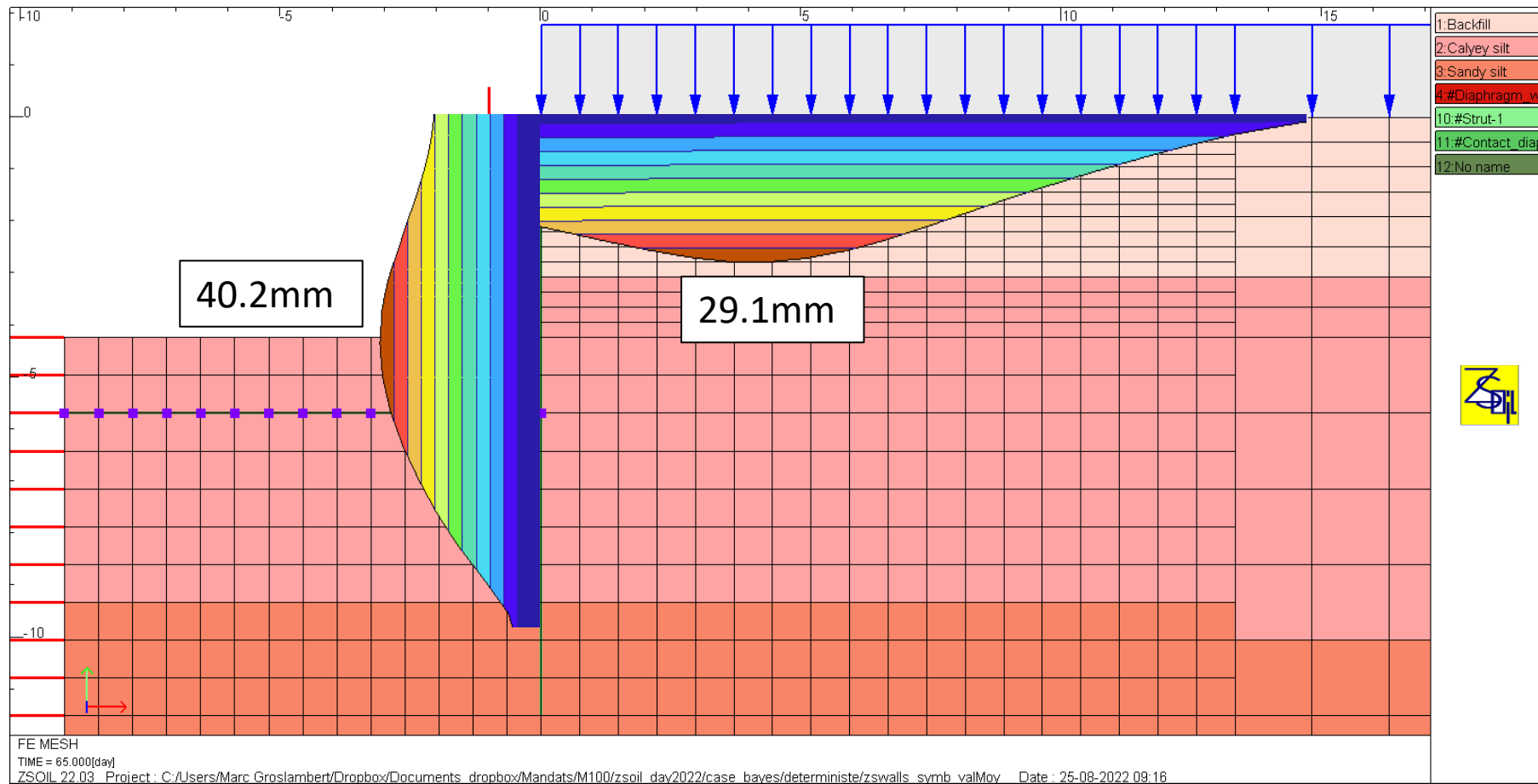

- **THANK YOU FOR YOUR ATTENTION...**

- **QUESTIONS?**

Acknowledgements

- Prof. Th. Zimmermann, Zace Ltd.
- Prof. Sudret, Dr Marelli, ETHZ
- My colleagues @GeoMod